

SL-889

Size: 1/10D

> XOL – extended operating life

Performance Data

(Typical values for batteries stored at +25 °C for one year)

| | |
|-----------------------------------|--------------------------|
| System | Lithium Thionyl Chloride |
| Nominal voltage | 3.6 V |
| Nominal capacity | 1 Ah |
| Nominal current | 0.5 mA |
| Max. continuous discharge current | 10 mA |
| Pulse current capability | 20 mA |
| Anode surface area | 7.5 cm ² |
| Lithium content | 0.3 g |
| Weight | 16 g |
| Volume | 5 cm ³ |
| Temperature range | -55 °C ... +85 °C |



Typical Discharge Curves at +25 °C

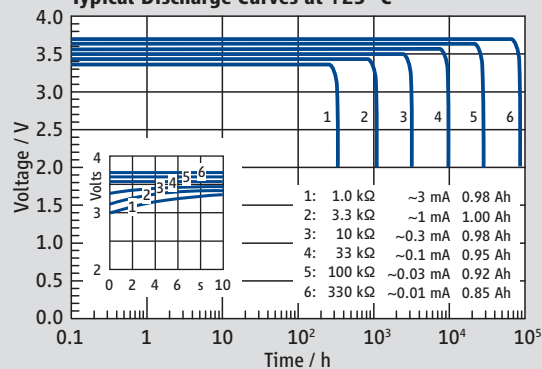

Available Capacity

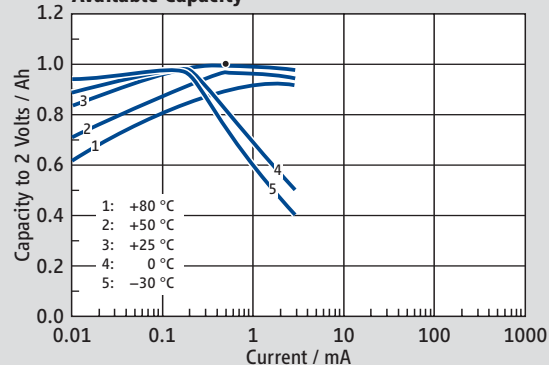

Operating Voltage

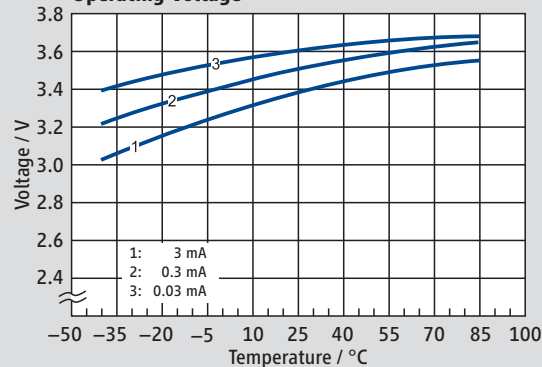

SL-889

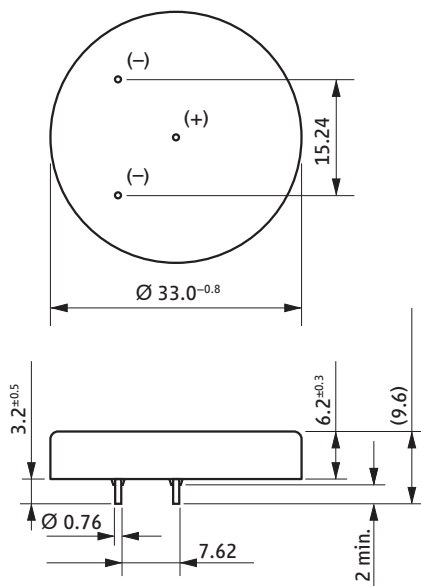

WARNING:
 Fire, explosion, and severe burn hazard. Do not recharge, disassemble, heat above 100 °C, incinerate, or expose contents to water.

Available Terminations

SL-889/P Pins

Catalogue No.

11 1 18894 00

Any values given here are for informational purposes only. They also depend on actual conditions of use and are not warranties of future performance. Subject to change.